

into

the Nordic Silence

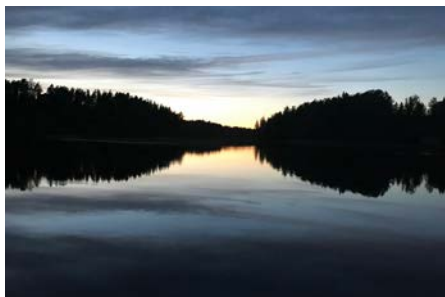





We make your office work.

INTO Concept, founded by Finnish designers, interior architect Hanna Gullstén and architect Jari Inkinen, is a furniture company that specializes in support space solutions and modular POD meeting rooms.

With more than 30 years of experience in designing functional workspaces, our INTO the Nordic Silence concept has been created to solve various distractions in open-plan offices and educational environments.

Our designs are inspired by the silence of Nordic nature and the colors of the seasons of the year. By following the Nordic tradition of high-quality and functional design, our pods and furniture create comforting and inviting havens to retreat to during the day.

We believe that everyone deserves a functional and healthy working environment.

Designers & Founders

Jari Inkinen

Hanna Gullstén



INDEX

We make your office work	3	Accessories	48
Index	5	POD room accessories	50
Values	6	CUBE armrest	50
Sustainability	8	STORY WALL accessories	51
POD Rooms	10	Standard materials	52-55
POD characteristics	12	Close-up pictures	56-57
POD PHONE SMALL & POD PHONE	14-15	Reference pictures	58-59
POD 1 & POD 2	18-19		
POD 4 & POD add-ons	20-21		
POD furniture examples	22-23		
POD ROLL characteristics	24		
POD ROLL & POD ROLL GLASS	26-27		
How to place your POD rooms	29		
Tables & Workstations	30		
TOP LIFT & TOP	32-33		
FOCUS & ROLL IN	34-35		
Seating	36		
CUBE & CUBE SOLO	38-39		
POINT CUP & POINT sofas	40-41		
POINT example solutions	42		
Space dividers	44		
STORY WALL	46		
STORY WALL example solutions	47		

CONTACT

INTO Concept Oy
Lemuntie 3-5 C
00510 Helsinki, FINLAND
tel: +358 40 670 7819
contact@intoconcept.com
www.intoconcept.com

INTO

the Nordic Silence

VALUES

CUSTOMER-FIRST

INTO the Nordic Silence furniture concept was created to help our customers; to put our customers first so that they could have healthy and functional working environments. Today, we come to our decisions with the customer in mind.

ENTREPRENEURIAL APPROACH

We encourage an entrepreneurial approach: to seek and find one's own strengths and to constantly develop and look for alternative solutions.

TOGETHER FORWARD

The best result is achieved together. We prefer working closely with one another and as a team with our customers, suppliers, and partners. Teamwork makes a dream work.

CAN-DO ATTITUDE

We aim to the stars and take our team with us. A good attitude and a positive mind keep us going.



INTO

the Nordic Silence

ENVIRONMENTAL SUSTAINABILITY

Due to our mission to be a pioneer in the sustainable development of the industry, our principle is to create furniture and accessories of such a high quality that they need never be thrown away. Manufactured in Finnish and Baltic factories, our products comply with the principles of sustainable development and general safety and durability requirements.

MATERIALS

All the materials used in INTO furniture are carefully chosen based on their ability to withstand heavy wear. It is important to us to use materials that are environmental-friendly from their long-lasting life cycle to recycling. Materials used for INTO furniture from fabrics to carpets to POD frames all comply with one or more sustainability certificates or standards. You can find our materials at the end of this brochure, on pages 52-55.

SOCIAL SUSTAINABILITY - FURNITURE FOR WELLBEING

Social sustainability is one of four aspects of sustainability. The main concept behind social sustainability is to create successful and functional places that promote wellbeing by understanding what people need from the places they live and work. INTO furniture can reduce the environmental load generated from office layout changes happening due to changing workspace needs. With our furniture solutions, more versatile, flexible, and multi-functional spaces that endure time can be created.



POD ROOMS

INTO the Nordic Silence POD rooms are originally created for real-life interior projects.

INTO POD rooms are designed and developed by interior architect and architect with decades of experience in designing functional spaces.

Here is why INTO POD rooms are the best in the market:

- Various size options to choose from.
- Timeless and classic design that aims to offer room-like spaces, not just glass boxes, to work in.
- Sound reduction index equals a well-made meeting room built on-site.
- We have tackled both visual and noise pollution to ensure maximal privacy.
- Our adjustable flooring system allows placing the POD rooms anywhere needed.
- Our POD rooms are for everyone.
Low thresholds enable easy usage with or without a wheelchair ramp.
- PODS can easily be placed next to each other without leaving gaps in the corners to collect dust and dirt.

Most importantly, our clean-lined and smart design makes INTO POD rooms timeless and highly adaptable.





POD CHARACTERISTICS

DESIGN

INTO the Nordic Silence products are designed by our INTO design team in Finland. Clean-lined and smart design makes all INTO the Nordic Silence products timeless and highly adaptable.

QUALITY

INTO POD rooms are known for their quality. All used materials are carefully chosen based on their ability to withstand heavy wear typical to public spaces.

ROOM-LIKE APPEARANCE

INTO POD rooms are designed to look like actual rooms to increase user comfort. Our POD rooms have straight corners so they can be placed next to each other without leaving gaps for dust and dirt to gather. Bigger rooms also have floor lamps to bring extra light and coziness.

ACCESSIBILITY

INTO POD rooms are for everyone. As standard, accessibility has been taken into account with the low doorstep, floor, and door width. There is an option to install a wheelchair ramp.

MODERN AUTOMATION

INTO POD rooms are equipped with a motion detector that automatically starts the ventilation and lighting when you walk into the POD. Automation also shuts down everything when the POD is not in use. Bigger POD rooms also include INTO's control system for boosted ventilation and lights.

WHEELS

POD rooms come with installation wheels to help with POD placement.

ACOUSTICS

Sound reduction in INTO POD rooms is one of the best in the market. PODS' excellent sound-damping properties are achieved with acoustic ceiling panels and acoustic wool in the walls. The walls are covered with sound-absorbing carpet. Together these features create high-quality silent spaces.

CAN BE PLACED ANYWHERE

The adjustable raised flooring system allows POD installation on uneven floor surfaces. The floor is covered with carpet, which can be replaced when needed.

EASY INSTALLATION

INTO POD is a modular, free-standing, and fully enclosed room, which can be installed, taken apart, and relocated. The installation doesn't require separate HVAC -installation - simply plug & play.

INDEPENDENT VENTILATION

A standard POD includes a self-contained ventilation system. There is an option to connect the POD to the building's own ventilation system.

PRIVACY

INTO POD rooms tackle both visual and noise pollution to enhance your focus. Our POD rooms have one big glass window wall, making the PODS more room-like, cozy and private.

HANDEDNESS

POD rooms are available both left and right handed.



POD ROOMS

POD PHONE SMALL

POD PHONE SMALL telephone booth improves privacy by providing silent space for phone calls. Despite its compact size, this telephone booth does not lose the sense of space or its visual protection.

All POD rooms are available with multiple surface and door materials. Ceiling panels have various color options and the POD rooms are available both right- and left-handed. Standard materials are displayed in pages 52-55.



Surface: white melamine, door: glass, carpet: dark grey, ceiling panel: light grey.

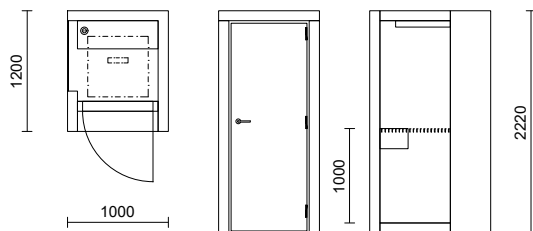

POD PHONE

POD PHONE improves privacy when taking phone calls in adaptable workspaces and office environments. Its insulating structure offers excellent acoustic protection from disruptive sounds. POD PHONE can accommodate a chair.

All POD rooms are available with multiple surface and door materials. Ceiling panels have various color options and the POD rooms are available both right- and left-handed. Standard materials are displayed in pages 52-55.



Surface: black oak, door: American oak, carpet: medium grey, ceiling panel: black.

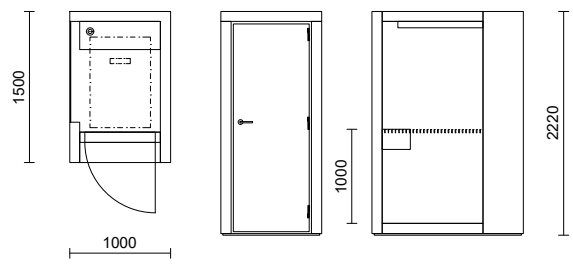





POD ROOMS

POD 1

POD 1 is the number one choice for private phone calls and online meetings and is an ideal workspace for tasks that demand focusing. POD 1 with an added wheelchair ramp works as a telephone booth for wheelchair users.

All POD rooms are available with multiple surface and door materials. Ceiling panels have various color options and the POD rooms are available both right- and left-handed. Standard materials are displayed in pages 52-55.



Surface: pine, door: glass, carpet: light grey, ceiling panel: green.

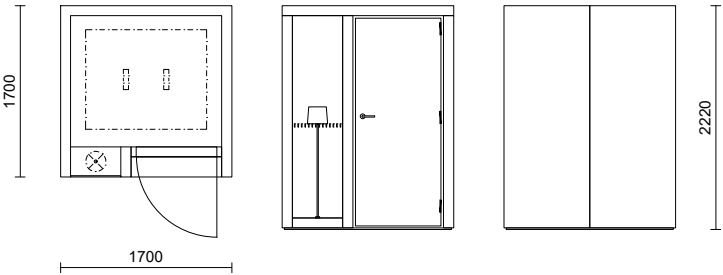

POD 2

POD 2 meeting room is ideal for spontaneous but confidential meetings and as an adaptable workspace. This small meeting room can be installed without changes on existing structure or walls, as well as reassembled in another location.

POD 2 is recommended for 2 people.

All POD rooms are available with multiple surface and door materials. Ceiling panels have various color options and the POD rooms are available both right- and left-handed. Standard materials are displayed in pages 52-55.



Surface: white melamine, door: white, carpet: light grey, ceiling panel: green.

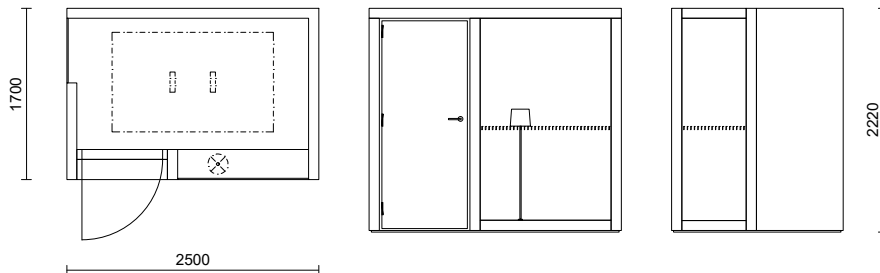

POD ROOMS

POD 4

POD 4 meeting room is perfect for private and confidential meetings as well as an adaptable working space. The acoustic protection in this meeting room is excellent due to its insulating structure.

POD 4 is recommended for 4 people.

All POD rooms are available with multiple surface and door materials. Ceiling panels have various color options and the POD rooms are available both right- and left-handed. Standard materials are displayed in pages 52-55.



Surface: American oak, door: glass, carpet: light grey, ceiling panel: light grey.

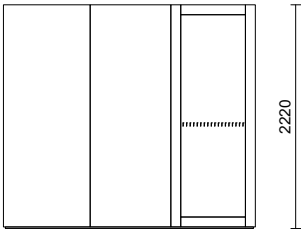
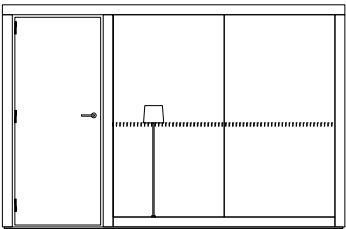
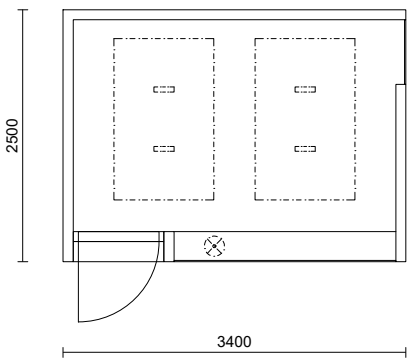

ADD-ONS FOR POD ROOMS

POD PANELS

INTO POD PANELS help you to create acoustic-friendly environments outside the POD rooms. They come with a quick and easy fastening system and do not leave any traces on POD surfaces. Multiple color options available.



DISPLAY BOX

DISPLAY BOX is a practical accessor specially designed to hold the screen in the POD meeting rooms. Furthermore, this wall solution makes it possible to hide the disruptive cables and remote control.

Please note that the screen and the wall mount brackets are not included.

WHEELCHAIR RAMP

A wheelchair ramp can be added to all POD 1-4. There is also an option to add several other features, such as:

- Reservation for automatic door
- Automatic door closer
- Hydraulic door closer
- Kick-plates for door and/or walls
- Vertical and/or horizontal bar handles



FURNITURE EXAMPLES FOR INTO POD ROOMS

POD PHONE



PHONE ALONE

A classic and timeless phone booth that retains privacy and prevents sound from escaping.

FURNITURE

Picture B: Active stool

A: POD PHONE SMALL

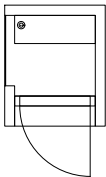

B: POD PHONE

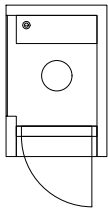

POD 1



PRIVATE WORK

Private workspace for 1 person when peace and quiet are needed for work that requires focus.

FURNITURE

Picture A: POINT LOW 500, TOP LIFT 400x600

Picture B: TOP LIFT 500x1000, office chair

A: POD 1

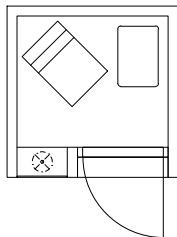

B: POD 1

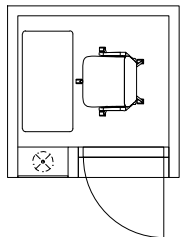

POD 2



THINK TANK

Creative space for 2 - 3 people. Furnished with cozy sofas and a height-adjustable table.

FURNITURE

Picture A: 2 x POINT LOW 700, TOP LIFT 400x600

Picture B: 2 x POINT LOW 500, POINT LOW 700, TOP 600x800

A: POD 1

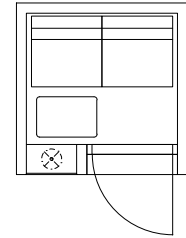

B: POD 2

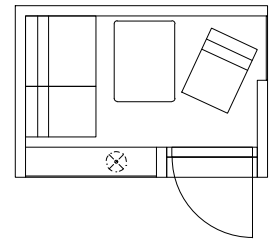

POD 4



TEAMWORK

A meeting room for teamwork. Furnished with sofas and side tables, as well as a display stand to support online meetings.

FURNITURE

Picture A: 4 x POINT LOW 700, POINT LOW CORNER, 2 x TOP LIFT CURVE, DISPLAY BOX

A: POD 4

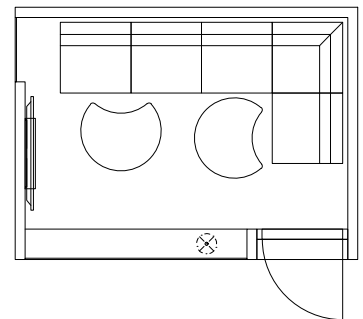

POD ROLL CHARACTERISTICS

POD ROLLS

POD ROLLS are ideal as adaptable space dividers and ad-hoc meeting points between breakout areas and office spaces. They can also be used in entrance halls to create sheltering workspaces for visitors. POD ROLLS are modular and movable freestanding rooms, which can be relocated by only moving them with bare hands. The installation doesn't require a separate HVAC installation -simply plug & play.

The seating measurements of the sofas are ergonomic and support healthy working positions.

POD ROLL ACOUSTICS

POD ROLL's sound-friendly qualities are achieved with the acoustic ceiling and wall panels, which are covered with high-class acoustical upholsteries. During test conditions, the POD ROLLS have good speech intelligibility. An optional glass door provide even better comfort.

MODERN AUTOMATION

INTO POD rooms are equipped with a motion detector that automatically starts the possible ventilation and lighting when the POD is occupied. Automation also shuts down everything when the POD is not in use.

FLOOR STRUCTURE

POD ROLL has wheels so that it can be easily moved and turned around on the premises. The floor covering is carpet, which can be replaced if needed.

COLOR OPTIONS FOR EXTERIOR

Standard color finishing options are white and grey. Customized colors and veneers are possible to the client's choice.

OPTIONS FOR INTERIOR

There is a range of fabrics with a variety of color options creating a pleasant acoustic environment to work in.

SOCKETS

POD ROLLS have sockets integrated into the tabletop as well as under the table.

VENTILATION

POD ROLLS do not need ventilation as they are open and semi-open solutions. POD ROLL GLASS as a closed solution has independent ventilation.

GLASS WALL

Laminated sound control glass wall includes INTO stripe manifestation design as standard delivery. Manifestation design can be tailored to match the client's brand identity when requested.

There is a possibility to attach a screen stand to the table.



INTO

The Nordic Silence

POD ROLL

POD ROLL

POD ROLL is a smart and compact solution for spontaneous meetings and independent work. POD ROLL includes built-in lighting and electrical socket on the tabletop. Because of its wheels, it can be easily moved and turned around within the premises.

There is an option to attach a screen stand to the table.

Standard materials are displayed in pages 52-55.



Surface: white melamine, carpet: dark grey.

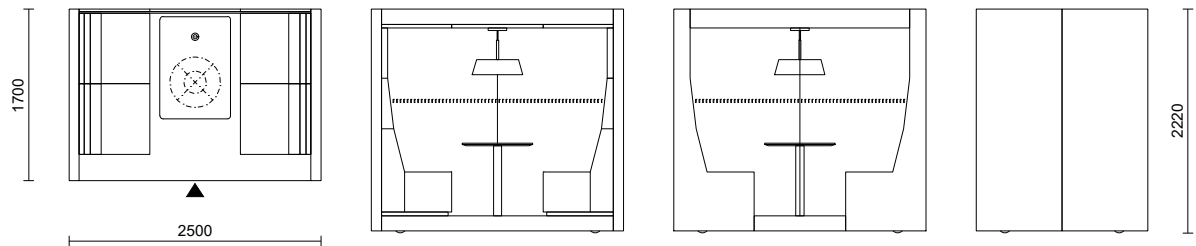

POD ROLL GLASS

POD ROLL GLASS is perfect for ad hoc meetings, work that needs focusing, and as a space divider and added seating space. Due to its wheels, POD ROLL GLASS can be easily moved and turned around within the premises. Electrical socket is on the tabletop.

There is an option to attach a screen stand to the table.

Standard materials are displayed in pages 52-55.



Surface: white melamine, carpet: dark grey, door: glass.

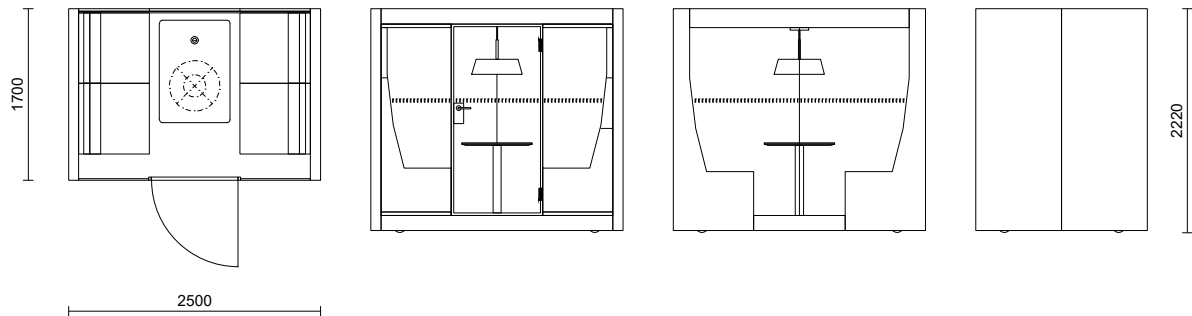



HOW TO PLACE YOUR POD ROOMS

INTO the Nordic Silence furniture concept was created to heal traditional open offices having challenges with noise to more focus-minded and functional working environments. INTO POD rooms increase both working comfort and productivity by providing cozy room-like acoustic and visual shelters. The most important thing in placing POD rooms is to place them close to the users so that they can be easily accessed. Especially important with phone booths is to place them into central areas so that they can be entered quickly.

POD rooms are meant to be used. You should have enough PODs of different sizes to serve various needs. POD PHONE telephone booths are ideal for quick calls. POD 1 & POD 2 are compact solutions for spontaneous meetings and independent work. PODs 2-4 are optimal for collaboration and teamwork, and POD 4 is a perfect meeting room.

In summary:

- Close to the users
- Phone booths to the central areas
- Right amount
- Diverse sizes
- POD rooms can be used as space dividers

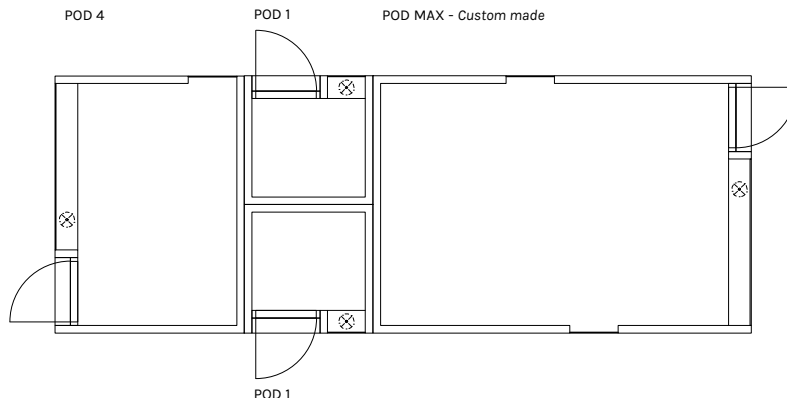
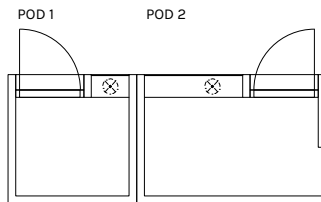

POD rooms can be positioned against each other due to their smart design. A straight-lined design means no gaps to gather dust or dirt.

TABLES & WORKSTATIONS

INTO tables and workstations are created to increase functionality and diverse usage of different spaces. They are perfect for entry halls, office spaces, educational environments, and private homes.

Why choose INTO tables and workstations?

- Perfect as drop-in workspaces.
- Use them to create spaces for quiet, individual work, or as space dividers.
- These ergonomic work stations can be used as a shelter against visual and noise pollution.

First and foremost, our tables and workstations enable flexible space planning for all needs.





TABLES & WORKSTATIONS

TOP LIFT

TOP LIFT tables support the INTO the Nordic Silence furniture family. With their adjustable base, TOP LIFT tables make it easy to change your working position. The adjustable leg functions with a gas spring, so there is no need for electricity.

Standard materials are displayed in pages 52-55.

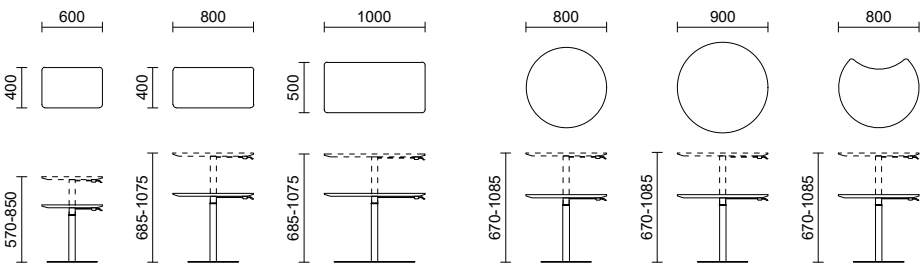

TOP

Our selection of TOP tables complements and supports the INTO the Nordic Silence product family. Visually slender but structurally steady table solutions enable ergonomic and flexible work.

Standard materials are displayed in pages 52-55.

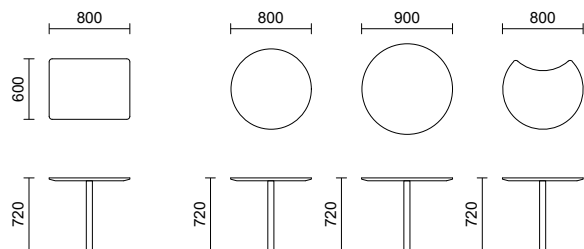

TABLES & WORKSTATIONS

FOCUS

This private workstation on wheels provides both visual haven and true peace of mind while working. It has fixed lighting as well as an electrical socket to charge your electrics.

Standard materials are displayed in pages 52-55.

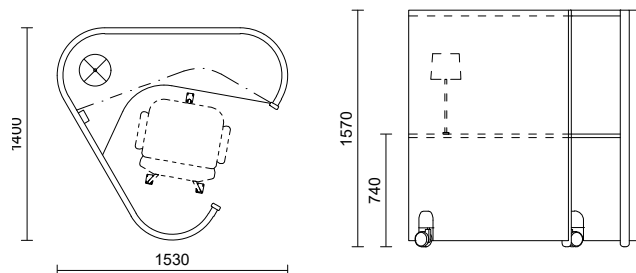

ROLL IN

ROLL IN is a workstation on wheels that offers a handy haven for those who need to focus in private during their workday. It includes fixed lighting, a built-in electrical socket as well as a hook to hold a bag.

Standard materials are displayed in pages 52-55.

Reference picture of ROLL IN with American oak surface in page 31.

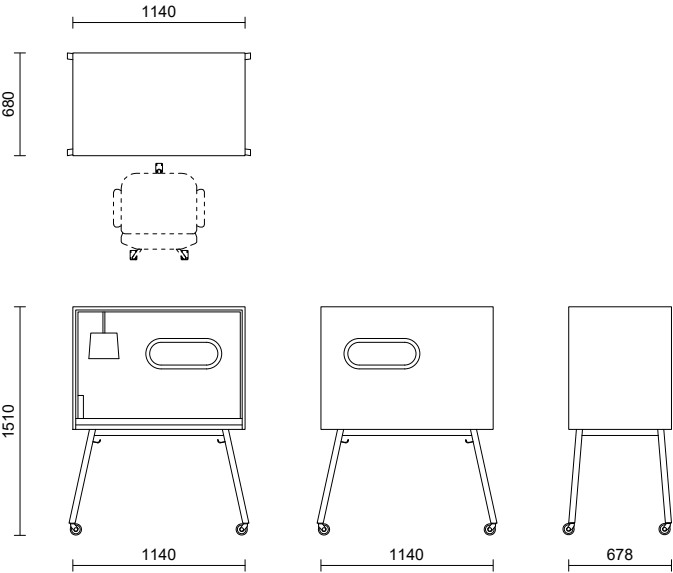

SEATING

INTO seating furniture is created to bring people together and to support collaboration. Our selection provides inviting solutions for working and learning environments.

Reasons to choose INTO seating furniture:

- Seating furniture is made for work and designed to withstand heavy wear typical to public spaces.
- Ergonomics have been taken into account with seating measurements that bases on standard office chair heights and sturdy structure to support healthy working positions.
- Electronical sockets can be integrated.
- Durable and comfortable materials that endure time.

Above all, we made things easy for you: choose a ready-made package solution or create the couch combination for your individual needs.





SEATING

CUBE

CUBE is an ideal solution for tiny spaces. This sheltered lounge sofa provides visual privacy with an acoustically friendly and comfortable environment. The ceiling has an opening for natural light to shine in.

Standard materials are displayed in pages 52-55.

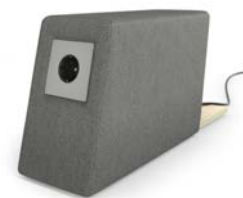
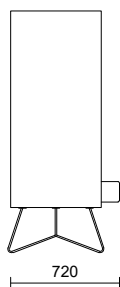
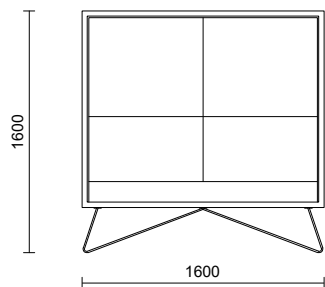
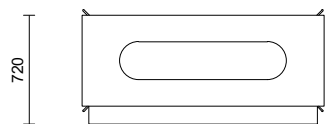

Option to add an armrest with a socket.

CUBE SOLO

CUBE SOLO is a rotating and sheltering chair for one person. It provides visual privacy within an acoustically friendly and comfortable environment. There is an opening in the ceiling for natural light to shine in.

Standard materials are displayed in pages 52-55.

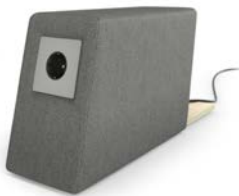
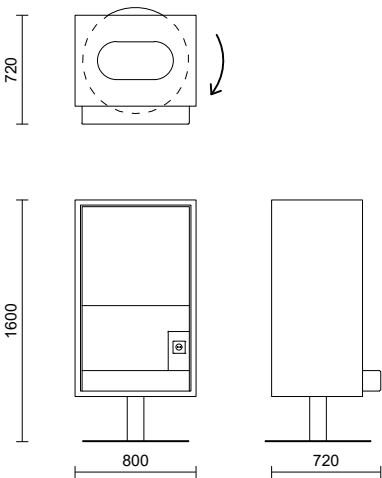
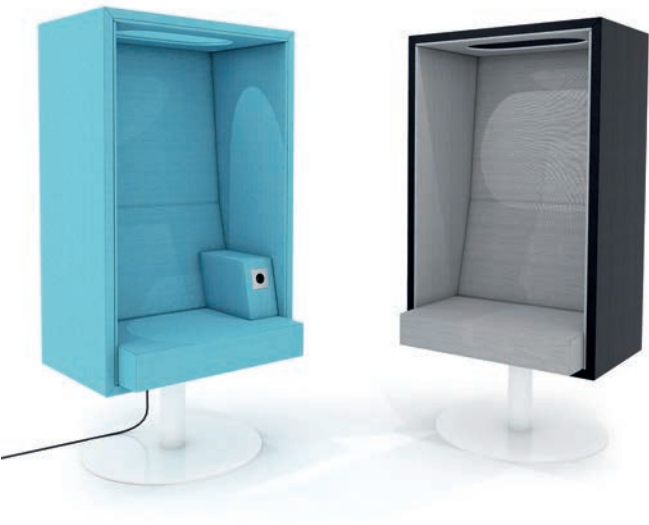

Option to add an armrest with a socket.

SEATING

POINT CUP

POINT CUP office booth is a sound-friendly 360-degree furniture solution that offers a comfortable space for teamwork and video conferences. The sofa modules of POINT CUP are upholstered with fabric and the backside of the screen wall is felt. The table includes an integrated electrical socket.

Standard materials are displayed in pages 52-55.

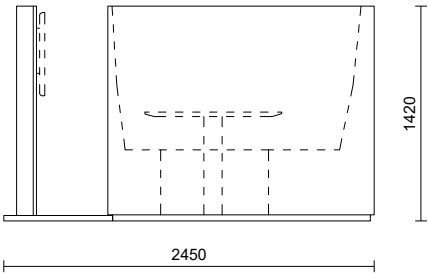
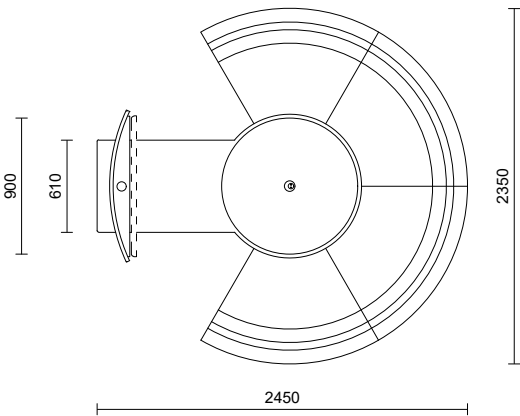

POINT SOFA MODULES

POINT is a flexible furniture solution for working and relaxing in offices, lounge environments, and entry halls. POINTS are individual sofa modules made of durable and comfortable materials that can be combined to create countless sofa combinations.

POINT sofas are available with wheels.
Note! Height with wheels is 480mm.



Standard materials are displayed in pages 52-55.

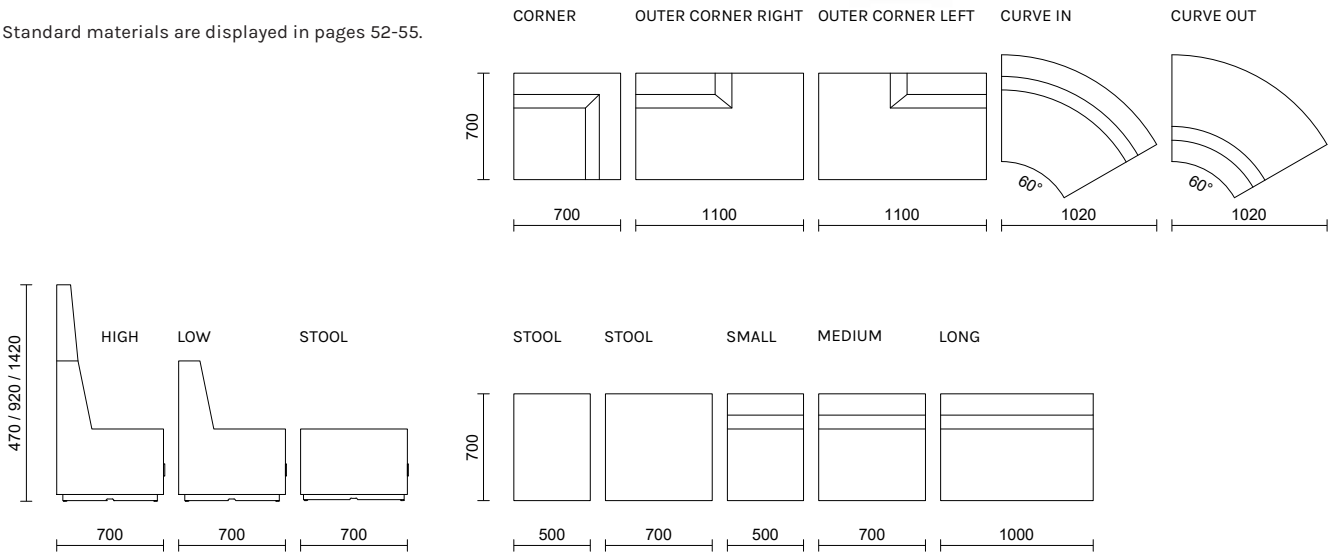

EXAMPLES OF POINT SOFA SETS

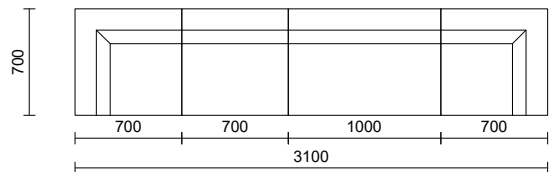

POINT LOW CORNER x 2, POINT LOW 700, POINT LOW 1000 with socket

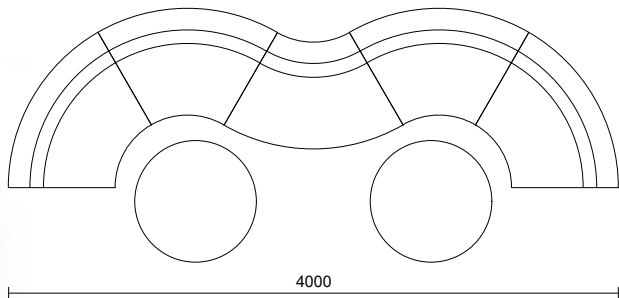

POINT CURVE IN HIGH x 4, POINT CURVE OUT HIGH x 1, TOP tables x 2

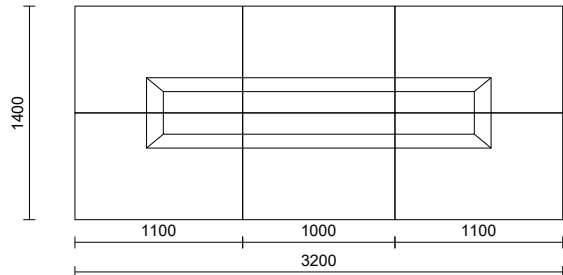

POINT OUTER CORNER LOW LEFT x 2, POINT OUTER CORNER LOW RIGHT x 2, POINT LOW 1000 x 2



SPACE DIVIDERS

Our acoustic space dividers create a pleasant sound environment, divides spaces, and provides space for creativity.

Why choose INTO space dividers?

- Beautiful timeless design fits any space.
- Due to built-in wheels, the space dividers can be moved and rotated around the premises.
- Create wall units by attaching the space dividers to each other with strong magnets.
- Durable and comfortable materials that endure time.





SPACE DIVIDERS

STORY WALL

The multi-purpose STORY WALL is an acoustical space divider that adapts to whatever space you're in. STORY WALL can be conveniently moved and turned around because of the wheels underneath. The walls attach to each other easily with strong magnets.

Option for add-on features such as whiteboard and tv bracket to make your STORY WALL a multi-functional idea wall.

Standard materials are displayed in pages 52-55.

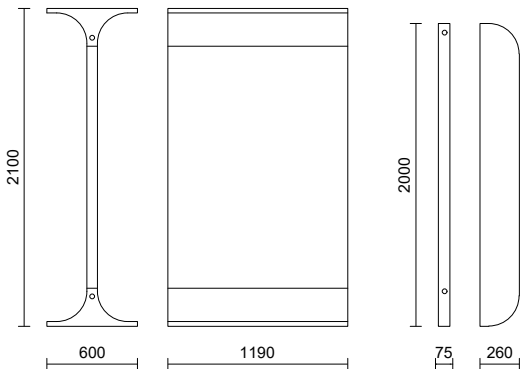

Add-on features for STORY WALL:
(details on page 51)

CORNER PIECE



TV BRACKET



WHITEBOARD



MARKER TRAY



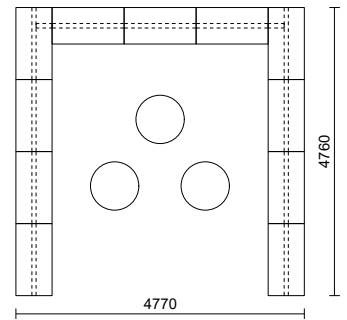

TOP LIFT ROUND x 3, STORY WALL x 11, CORNER PIECE x 2, WHITEBOARD x 8

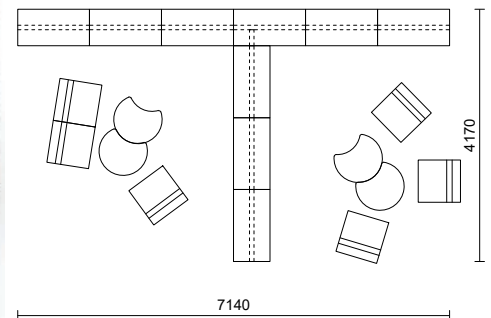

TOP CURVE x 4, STORY WALL x 9, CORNER PIECE x 1, WHITEBOARD x 4, POINT SOFAS x 6

ACCESSORIES

Our accessories solutions help you to transform your workplace into a multi-purpose and balanced environment.

INTO accessories consists of Finnish design pieces that will make your space even more functional.





ACCESSORIES

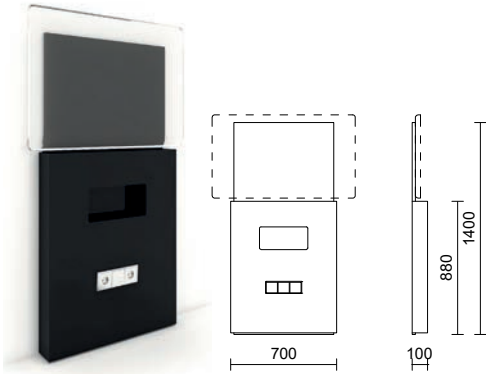

DISPLAY BOX FOR POD ROOMS

Turn your POD room into a functional conference room. Ideal for 42" screen.



POD PANELS FOR POD ROOMS

POD Panels help you to create a cozy and sound-friendly working environment for your team. Reference picture is displayed in page 49. Size: W500/600 x D45 x H2220 mm



WHEELCHAIR RAMP FOR POD ROOMS

Turn the POD room into an accessible room for everyone with a wheelchair ramp. Measurements: W900 x D880 x H42 mm



ARMREST FOR CUBE & CUBE SOLO

CUBE Armrest comes with a built-in electrical socket.

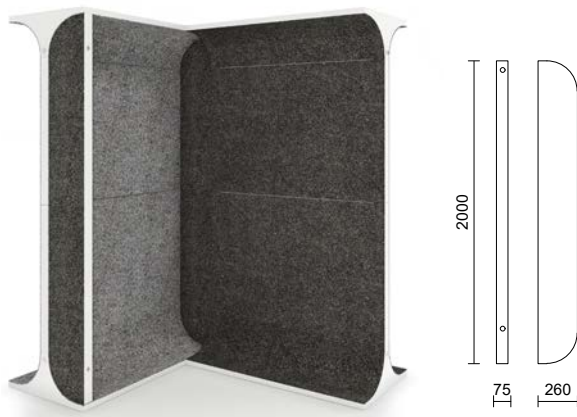

CORNER PIECE

Create corners and make room-like spaces.
Reference picture is displayed in page 47.
Size: W260 x H2000 mm



MAGNETIC WHITEBOARD

You can add 1-4 whiteboards to your STORY WALL.
The size for one whiteboard is W1120 x H790 mm.
Ask for other sizes. Attachable with magnets.



MARKER TRAY

Enhance your STORY WALL with a handy marker tray.
Easily attachable with magnets.
W1119 x D72 x H101 mm



TV BRACKET

Turn your space divider into a stylish screen holder.
TV Bracket comes with a marker tray that has an
extension cord holder.

STANDARD MATERIALS

SURFACE FINISHES: PODS, ROLL IN



White
melamine



Dark grey
melamine



Pine
veneer

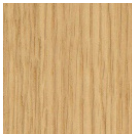

American oak
veneer

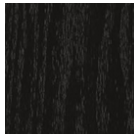

Black oak
veneer



DOOR OPTIONS: PODS



White
painted



American oak



Clear glass 10 mm
comes with white door panels

CARPETS: PODS

FLETCO: Ex-dono Quartet

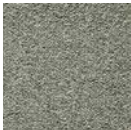

393300

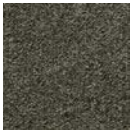

393340



393350

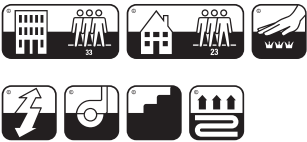



STANDARD MATERIALS

FABRICS: POD ROLLS, POINT sofas, POINT CUP, CUBE, CUBE SOLO

CAMIRA: Main Line Flax

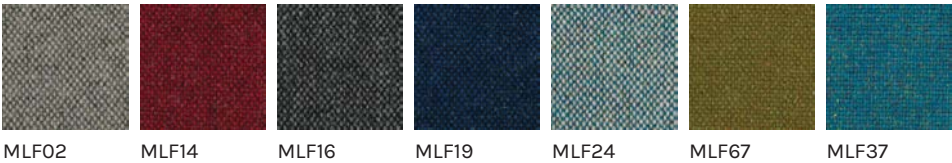

CAMIRA: Synergy



DELFOF FR: Pyton - Flame retardant synthetic with leather grain emboss.



breathable and flame
retardant quality



efficient material



long-life



easy-to-clean



aesthetic value

GABRIEL: SOUL - Panel fabric for ROLL IN, POD PANELS, POD CEILING PANELS

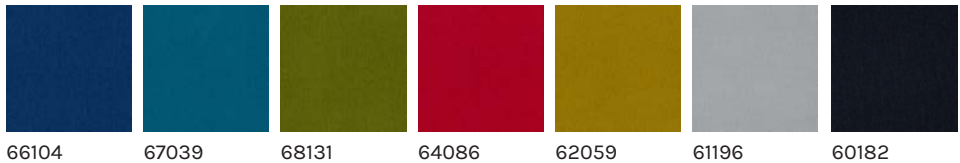

FELT: FOCUS, STORY WALL, POINT CUP

FILZFABRIC: Fulda Ment 60

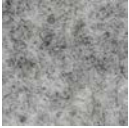

109



101

TABLE PAINT: TOP tables



NCS S 0500-N
Structural

TABLE STEEL TUBE BASE: TOP tables

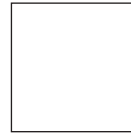

RAL 9016
White



RAL 9005
Black

Black or white laminate as an alternative.

INTO

the Nordic Silence



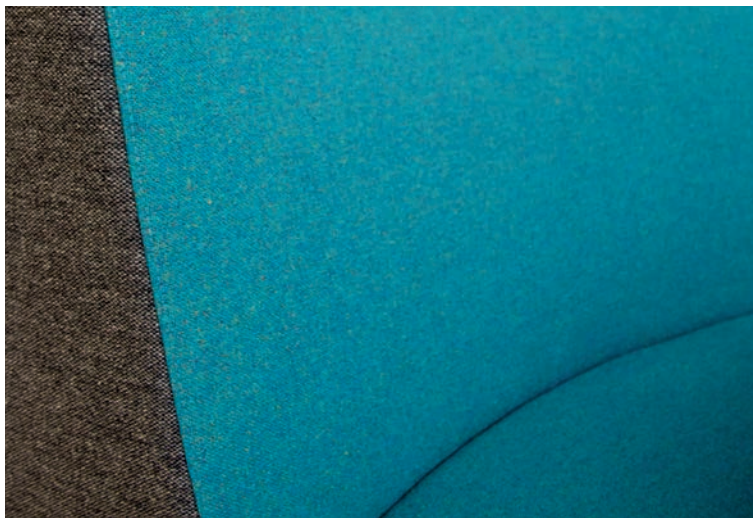

INTO

the Nordic Silence



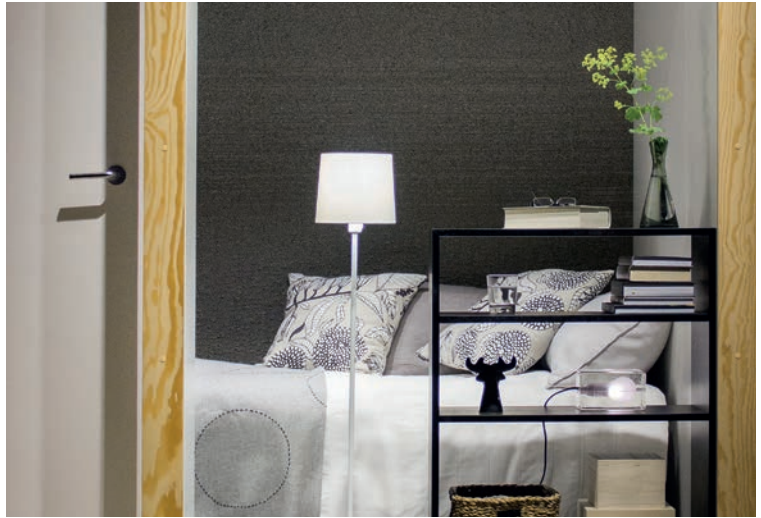

INTO the Nordic Silence

www.intoconcept.com

contact@intoconcept.com

INTO Concept reserves a right to make changes to the product portfolio and alter technical specifications without notice. Batch to batch variations may occur within commercial tolerance.

Front cover reference picture:
Trimble Headquarters, Finland

Back cover reference picture:
Finance company, Finland

03/2023

